

# TORSRAND AB

BJÄRNUM - SWEDEN



## TENT HALLS

# GAMMA

SPAN 15 TO 25 M

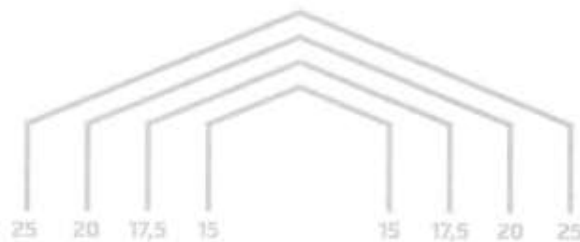

### Technical Description

The main structural profile size 253mm x 131mm x 3.0mm, or 307 x 116 x 3.7mm is made of Hard Pressed Extruded Structural Aluminum alloy, anodized according to QUALANOD:2004. Connecting components are made of S355 steel welded according to certificate SLV DIN 18800 and hot dipped galvanized according to standard PN EN ISO 1461 for perfect corrosion resistance.

Tent Halls are structures with no permanent anchoring to the ground.

As standard, the GAMMA structure is coated with PVC textile of specific weight about 670g/m<sup>2</sup> or 900g/m<sup>2</sup>. The textile is hardly flammable complying to: DIN 4102 B1 certified by MPA Universität Stuttgart (Otto-Graf-Institut), to DIN EN 13501-1: B-s2 d0 certified by IBS – Linz Institut für Brandschutztechnik und Sicherheitsforschung Gesellschaft m.b.H. and to M2 certified by IFTH site de Lyon.

Alternatively, sidewalls can be made of 0.5mm thick trapezoidal steel sheet T35, or 60.0mm thick sandwich panel in any color offered according to RAL table.

The Tent Hall is assembled on a well leveled, hard surface. GAMMA tents can be mounted on concrete footing. All Tent Halls are made according to technical documentation based on current standards and regulations.



# Torscand AB



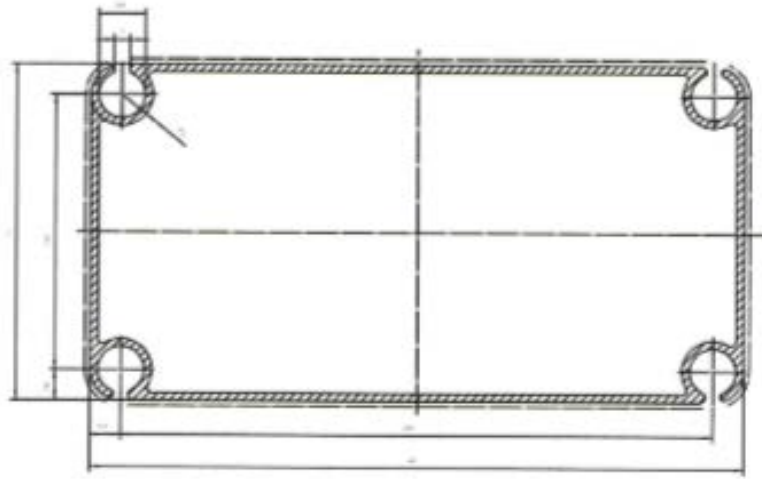

steel connector corner



steel connector top



feet side



feet forefront

## GAMMA halls

span 20,0 m

